

Property Map Jefferson Maine

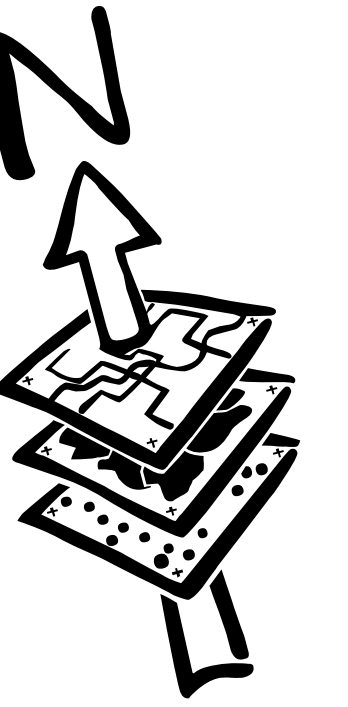

0 200 400 800 1,200
Feet

1 inch = 400 feet

Legend

- Streams
- Easements
- Road Type**
 - State Highway
 - Town Road
 - Private Way
 - Transmission Lines
- This Map
- Adjacent Maps
- Internal parcel lines
- Ponds
- Wetlands (NWI)
- Adjacent Towns

Source Documents:
 Jefferson Property Maps by James W. Sewall Co. dated 1977 and updated through 1998. Digitized by Maine Coast Surveying in 2009.
 Plans, deeds and other data supplied by the Town of Jefferson.
 Maine Office of Geographic Information Systems digital data layers.
 High resolution digital orthophotographs produced from aerial photos collected in the Spring of 2013.
 Road Class contains road centerline and road name data from NAD83 road data dated May 2, 2017 from the Maine Office of GIS.
 Streams depict single line streams of Maine from USGS 1:24,000 scale quadrangles.
 Wetlands (NWI) contain USFWS National Wetland Inventory polygon data for Maine at 1:24,000 scale.

For Assesment Purposes Only
 Not a Boundary Survey
 Not to be used for Conveyances

April 1, 2017

prepared by

**Maine Coast Surveying
& Flood Consultants**

187 Bath Road
 Wiscasset, Maine 04578
 (207) 563-1500

918 Brighton Avenue
 Portland, Maine 04102
 (207) 878-7870

Map 1

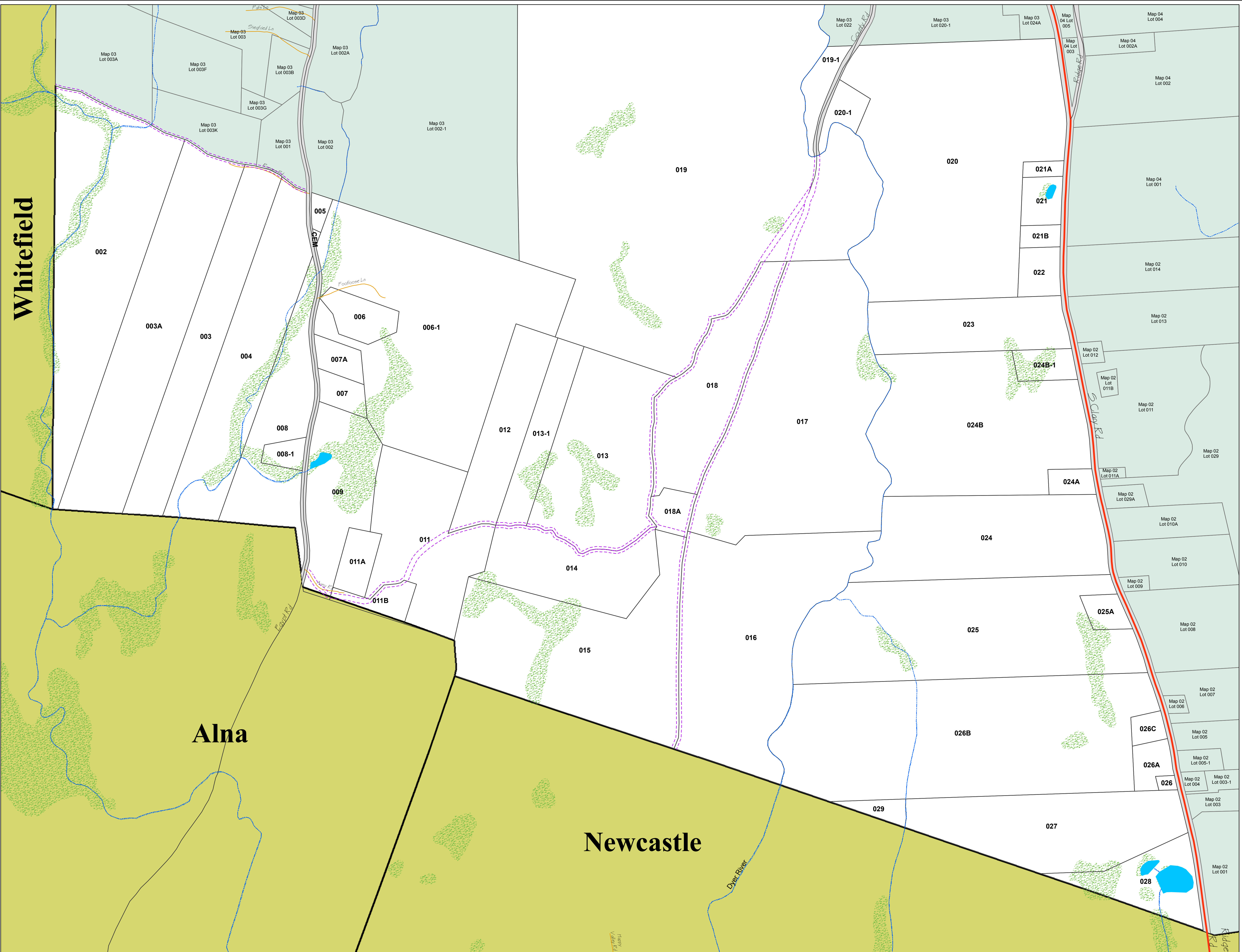

Whitefield

Alna

Newcastle